

Lichtpunktabstand/Light point distance:	40mm, 80mm
Treiber/Driver:	Extern/External
Leistung/Wattage:	6W – 72W
Leuchtenlichtstrom/Real Luminous Flux:	694 lm – 7405 lm
Lichtverteilung/Beam angle:	Asymmetrisch/Asymmetric
Max. Wirkungsgrad/Max. Efficiency:	ca. 85%
Farbtemperatur/Color Temperature:	2200K – 5700K
CRI:	>80, >90
Schutzklasse/Protection Class:	I
Schutzart/IP-Protection:	IP20
Oberfläche Gehäuse/Casing Finish:	Pulverbeschichtet/Powder Coated
Sonderausführung/Custom versions:	Auf Anfrage/On request

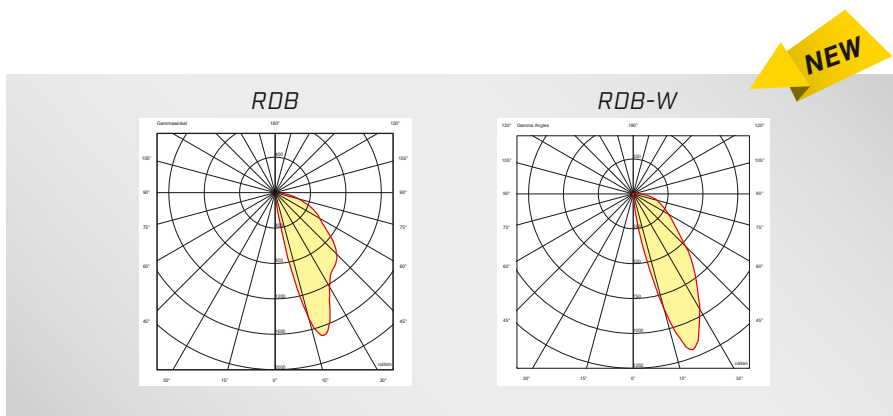

MONO

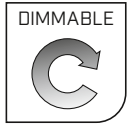

FFF RDB ANBAU / SURFACE MOUNTED LP40

Lichtpunktabstand 40mm / Light point distance 40mm

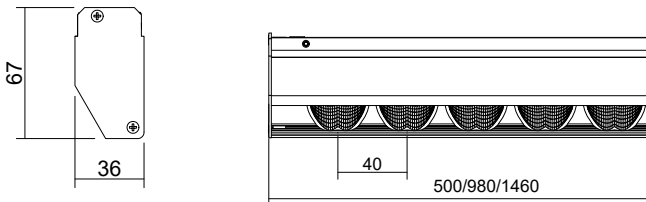

Produkt ID Länge / length	Bestromung, Leistung + Lichtstrom/ Current, wattage + luminous flux		
	@350mA	@500mA	@700mA
001 = 1W / LED	015 = 1,5W / LED	002 = 2W / LED	
1898 = 500mm	12W / 1387 lm	18W / 1856 lm	24W / 2468 lm
1899 = 980mm	24W / 2774 lm	36W / 3713 lm	48W / 4937 lm
1900 = 1460mm	36W / 4162 lm	54W / 5569 lm	72W / 7405 lm

für/for 3000K, CRI90 Weitere Ausführungen auf Anfrage / Other versions on request

FFF RDB ANBAU / SURFACE MOUNTED LP80

Lichtpunktabstand 80mm / Light point distance 80mm

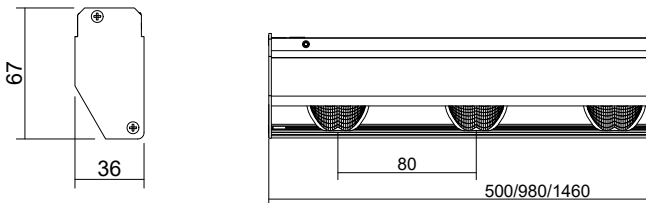

Produkt ID Länge / length	Bestromung, Leistung + Lichtstrom/ Current, wattage + luminous flux		
	@350mA	@500mA	@700mA
001 = 1W / LED	015 = 1,5W / LED	002 = 2W / LED	
1901 = 500mm	6W / 694 lm	9W / 928 lm	12W / 1234 lm
1902 = 980mm	12W / 1387 lm	18W / 1856 lm	24W / 2468 lm
1903 = 1460mm	18W / 2081 lm	27W / 2785 lm	36W / 3703 lm

für/for 3000K, CRI90 Weitere Ausführungen auf Anfrage / Other versions on request

Lichtquelle Energieeffizienz Light source energy efficiency 3000K			



ARTIKELNUMMER / ARTICLE NUMBER:

Produktkennung Product ID	Verbrauch Wattage	Treiber Driver	Abstrahlwinkel Beam Angle	Farbtemperatur Color Temperature	CRI CRI	Farbe Color Finish	Extras Accessories
1898	001 = 1W	X = Ohne/None	000 = RDB	27 = 2700K	8 = 80	01 = RAL 9016 ○	X = Ohne/None
1899	015 = 1,5W	Y = DALI		30 = 3000K	9 = 90	02 = RAL 9006 ●	
1900	002 = 2W	Z = On/Off		35 = 3500K		03 = RAL 9005 ●	
1901				40 = 4000K		04 = RAL 7016 ●	
1902				50 = 5000K*		05 = DB703 ●	
1903				57 = 5700K*			

Andere Farbkombinationen oder Temperaturen möglich / Other color combinations or temperatures possible
*5000K und 5700K nur CRI 80 / 5000K and 5700K only CRI 80

TUNABLE WHITE

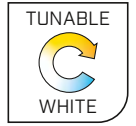
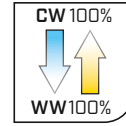

FFF RDB ANBAU / SURFACE MOUNTED LP40

Lichtpunktabstand 40mm / Light point distance 40mm

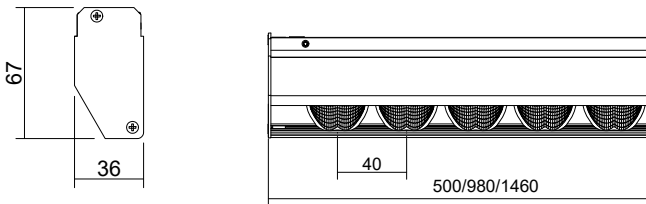

Produkt ID Länge / length	Bestromung, Leistung + Lichtstrom/ Current, wattage + luminious flux
1904 = 500mm	24W / (1795 lm / 2264 lm)
1905 = 980mm	48W / (3590 lm / 4529 lm)
1906 = 1460mm	72W / (5386 lm / 6793 lm)

für/for 2700K-5000K, CRI90 und 2x38° Weitere Ausführungen auf Anfrage / Other versions on request

FFF RDB ANBAU / SURFACE MOUNTED LP80

Lichtpunktabstand 80mm / Light point distance 80mm

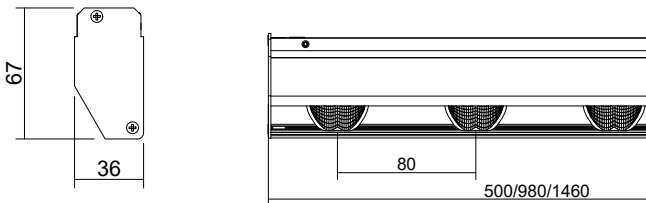

Produkt ID Länge / length	Bestromung, Leistung + Lichtstrom/ Current, wattage + luminious flux
1907 = 500mm	12W / (898 lm / 1132 lm)
1908 = 980mm	24W / (1795 lm / 2264 lm)
1909 = 1460mm	36W / (2693 lm / 3397 lm)

für/for 2700K-5000K, CRI90 und 2x38° Weitere Ausführungen auf Anfrage / Other versions on request

Lichtquelle Energieeffizienz
Light source energy efficiency
2700K - 5000K



ARTIKELNUMMER / ARTICLE NUMBER:



Produktkennung Product ID	Verbrauch Wattage	Treiber Driver	Abstrahlwinkel Beam Angle	Farbtemperatur Color Temperature	CRI CRI	Farbe Color Finish	Extras Accessories
1904	002 = 2W	X = Ohne/None	000 = RDB	T1 = 2200K - 4000K	8 = 80	01 = RAL 9016 ○	X = Ohne/None
1905		W = DALI DT8		T2 = 2200K - 4500K	9 = 90	02 = RAL 9006 ●	
1906				T3 = 2200K - 5000K		03 = RAL 9005 ●	
1907				T4 = 2200K - 5700K*		04 = RAL 7016 ●	
1908				T5 = 2700K - 4000K		05 = DB703 ●	
1909				T6 = 2700K - 4500K			
				T7 = 2700K - 5000K			
				T8 = 2700K - 5700K*			

Andere Farbkombinationen oder Temperaturen möglich / Other color combinations or temperatures possible
*5700K nur CRI 80 / 5700K only CRI 80

MONO

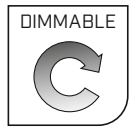

FFF RDB-W HALBEINBAU / SEMI RECESSED LP40

Lichtpunktabstand 40mm / Light point distance 40mm

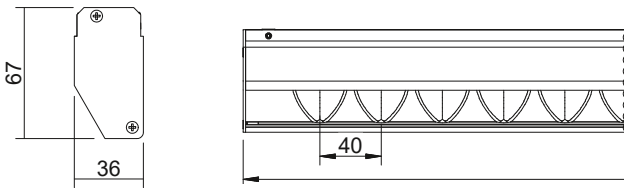

Produkt ID Länge / length	Bestromung, Leistung + Lichtstrom/ Current, wattage + luminous flux		
	@350mA 001 = 1W / LED	@500mA 015 = 1,5W / LED	@700mA 002 = 2W / LED
2775 = 500mm	12W / 1387 lm	18W / 1856 lm	24W / 2468 lm
2776 = 980mm	24W / 2774 lm	36W / 3713 lm	48W / 4937 lm
2777 = 1460mm	36W / 4162 lm	54W / 5569 lm	72W / 7405 lm

für/for 3000K, CRI90 Weitere Ausführungen auf Anfrage / Other versions on request

FFF RDB-W HALBEINBAU / SEMI RECESSED LP80

Lichtpunktabstand 80mm / Light point distance 80mm

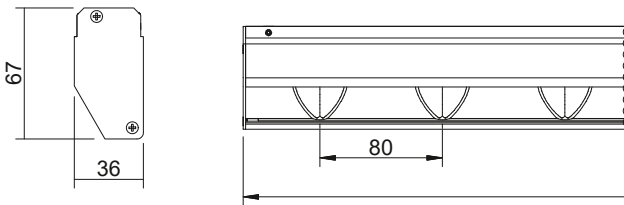

Produkt ID Länge / length	Bestromung, Leistung + Lichtstrom/ Current, wattage + luminous flux		
	@350mA 001 = 1W / LED	@500mA 015 = 1,5W / LED	@700mA 002 = 2W / LED
2778 = 500mm	6W / 694 lm	9W / 928 lm	12W / 1234 lm
2779 = 980mm	12W / 1387 lm	18W / 1856 lm	24W / 2468 lm
2780 = 1460mm	18W / 2081 lm	27W / 2785 lm	36W / 3703 lm

für/for 3000K, CRI90 Weitere Ausführungen auf Anfrage / Other versions on request

Lichtquelle Energieeffizienz
Light source energy efficiency
3000K



ARTIKELNUMMER / ARTICLE NUMBER:



Produktkennung Product ID	Verbrauch Wattage	Treiber Driver	Abstrahlwinkel Beam Angle	Farbtemperatur Color Temperature	CRI CRI	Farbe Color Finish	Extras Accessories
2775	001 = 1W	X = Ohne/None	00W = RDB-W	27 = 2700K	8 = 80	01 = RAL 9016 ○	X = Ohne/None
2776	015 = 1,5W	Y = DALI		30 = 3000K	9 = 90	02 = RAL 9006 ●	
2777	002 = 2W	Z = On/Off		35 = 3500K		03 = RAL 9005 ●	
2778				40 = 4000K		04 = RAL 7016 ●	
2779				50 = 5000K*		05 = DB703 ●	
2780				57 = 5700K*			

Andere Farbkombinationen oder Temperaturen möglich / Other color combinations or temperatures possible
*5000K und 5700K nur CRI 80 / 5000K and 5700K only CRI 80

TUNABLE WHITE

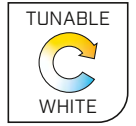
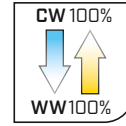

FFF RDB-W ANBAU / SURFACE MOUNTED LP40

Lichtpunktabstand 40mm / Light point distance 40mm

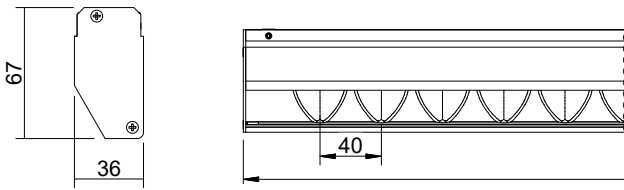

Produkt ID Länge / length	Bestromung, Leistung + Lichtstrom/ Current, wattage + luminous flux
	002 = max. 2W per Lichtpunkt / Light point @700mA
2781 = 500mm	24W / (1795 lm / 2264 lm)
2782 = 980mm	48W / (3590 lm / 4529 lm)
2783 = 1460mm	72W / (5386 lm / 6793 lm)

für/for 2700K-5000K, CRI90 und 2x38° Weitere Ausführungen auf Anfrage / Other versions on request

FFF RDB-W ANBAU / SURFACE MOUNTED LP80

Lichtpunktabstand 80mm / Light point distance 80mm

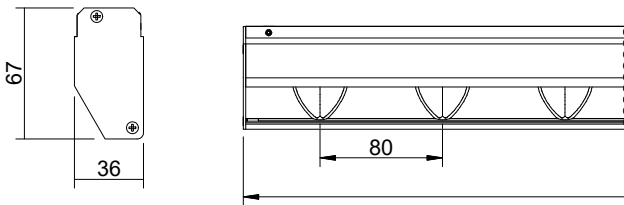

Produkt ID Länge / length	Bestromung, Leistung + Lichtstrom/ Current, wattage + luminous flux
	002 = max. 2W per Lichtpunkt / Light point @700mA
2784 = 500mm	12W / (898 lm / 1132 lm)
2785 = 980mm	24W / (1795 lm / 2264 lm)
2786 = 1460mm	36W / (2693 lm / 3397 lm)

für/for 2700K-5000K, CRI90 und 2x38° Weitere Ausführungen auf Anfrage / Other versions on request

Lichtquelle Energieeffizienz
Light source energy efficiency
2700K - 5000K



Produktkennung Product ID	Verbrauch Wattage	Treiber Driver	Abstrahlwinkel Beam Angle	Farbtemperatur Color Temperature	CRI CRI	Farbe Color Finish	Extras Accessories
2781	002 = 2W	X = Ohne/None	00W = RDB-W	T1 = 2200K - 4000K	8 = 80	01 = RAL 9016 ○	X = Ohne/None
2782		W = DALI DT8		T2 = 2200K - 4500K	9 = 90	02 = RAL 9006 ●	
2783				T3 = 2200K - 5000K		03 = RAL 9005 ●	
2784				T4 = 2200K - 5700K*		04 = RAL 7016 ●	
2785				T5 = 2700K - 4000K		05 = DB703 ●	
2786				T6 = 2700K - 4500K			
				T7 = 2700K - 5000K			
				T8 = 2700K - 5700K*			

Andere Farbkombinationen oder Temperaturen möglich / Other color combinations or temperatures possible
*5700K nur CRI 80 / 5700K only CRI 80