

Lichtpunktabstand/Light point distance:	25mm, 50mm, 100mm
Treiber/Driver:	Integriert/Integrated
Leistung/Wattage:	5W – 90W
Leuchtenlichtstrom/Real Luminous Flux:	585 lm – 12487 lm
Lichtverteilung/Beam angle:	8°, 10°, 25°, 32°, 45°, Asymmetrisch/Asymmetric
Max. Wirkungsgrad/Max. Efficiency:	ca. 90%
Farbtemperatur/Color Temperature:	2200K – 5700K
CRI:	>80, >90
Schutzklasse/Protection Class:	I
Schutzart/IP-Protection:	IP20
Oberfläche Gehäuse/Casing Finish:	Pulverbeschichtet/Powder Coated
Sonderausführung/Custom versions:	Auf Anfrage/On request

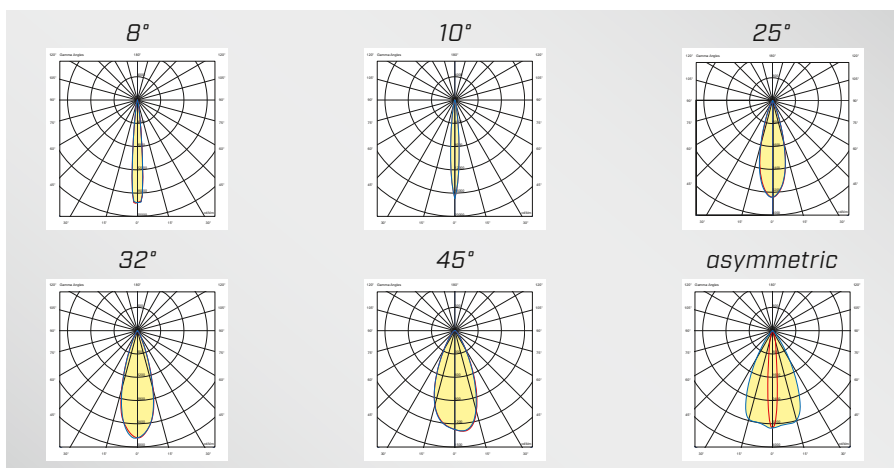

MONO

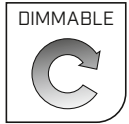

TINZO LINE 65 STROMSCHIENE / TRACK LP25

Lichtpunktabstand 25mm/Light point distance 25mm

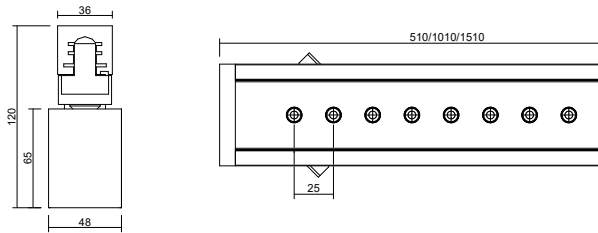

Produkt ID Länge / length	Bestromung, Leistung + Lichtstrom/ Current, wattage + luminous flux		
	@350mA 001 = 1W / LED	@500mA 015 = 1,5W / LED	@700mA 002 = 2W / LED
1824 = 510mm	20W / 2339 lm	30W / 3130 lm	40W / 4162 lm
1825 = 1010mm	40W / 4678 lm	60W / 6261 lm	80W / 8325 lm
1826 = 1510mm	60W / 7018 lm	90W / 9391 lm	120W / 12487 lm

für/for 3000K, CRI90, 25°. Weitere Ausführungen auf Anfrage / Other versions on request

TINZO LINE 65 STROMSCHIENE / TRACK LP50

Lichtpunktabstand 50mm/Light point distance 50mm

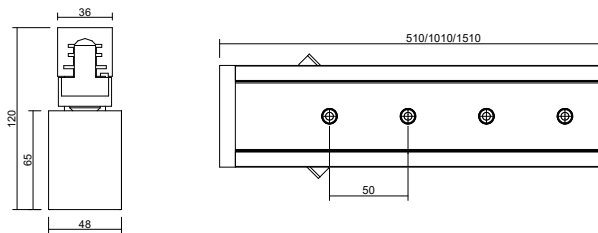

Produkt ID Länge / length	Bestromung, Leistung + Lichtstrom/ Current, wattage + luminous flux		
	@350mA 001 = 1W / LED	@500mA 015 = 1,5W / LED	@700mA 002 = 2W / LED
1827 = 510mm	10W / 1170 lm	15W / 1565 lm	20W / 2081 lm
1828 = 1010mm	20W / 2339 lm	30W / 3130 lm	40W / 4162 lm
1829 = 1510mm	30W / 3509 lm	45W / 4696 lm	60W / 6224 lm

für/for 3000K, CRI90, 25°. Weitere Ausführungen auf Anfrage / Other versions on request

TINZO LINE 65 STROMSCHIENE / TRACK LP100

Lichtpunktabstand 100mm/Light point distance 100mm

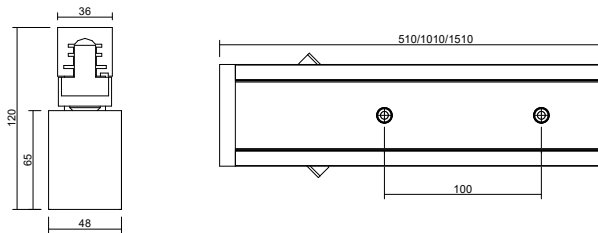

Produkt ID Länge / length	Bestromung, Leistung + Lichtstrom/ Current, wattage + luminous flux		
	@350mA 001 = 1W / LED	@500mA 015 = 1,5W / LED	@700mA 002 = 2W / LED
1830 = 510mm	5W / 585 lm	7,5W / 783 lm	10W / 1041 lm
1831 = 1010mm	10W / 1170 lm	15W / 1565 lm	20W / 2081 lm
1832 = 1510mm	15W / 1754 lm	23W / 2348 lm	30W / 3122 lm

für/for 3000K, CRI90, 25°. Weitere Ausführungen auf Anfrage / Other versions on request

Lichtquelle Energieeffizienz Light source energy efficiency 3000K			
---	--	--	--



ARTIKELNUMMER / ARTICLE NUMBER:



Produktkennung Product ID	Verbrauch Wattage	Treiber Driver	Abstrahlwinkel Beam Angle	Farbtemperatur Color Temperature	CRI CRI	Farbe Color Finish	Extras Accessories
1824	001 = 1W	X = Ohne/None	A = Asymmetric	27 = 2700K	8 = 80	01 = RAL 9016 ○	X = Ohne/None
1825	015 = 1,5W	Y = DALI	f = 8°	30 = 3000K	9 = 90	02 = RAL 9006 ●	
1826	002 = 2W	Z = On/Off	g = 10°	35 = 3500K		03 = RAL 9005 ●	
1827			T = 25°	40 = 4000K		04 = RAL 7016 ●	
1828			h = 32°	50 = 5000K*		05 = DB703 ●	
1829			W = 45°	57 = 5700K*			
1830							
1831							
1832							

Andere Farbkombinationen oder Temperaturen möglich/Other color combinations or temperatures possible

*5000K und 5700K nur CRI 80/ 5000K and 5700K only CRI 80

TUNABLE WHITE

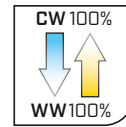

TINZO LINE 65 STROMSCHIENE / TRACK LP25

Lichtpunktabstand 25mm / Light point distance 25mm

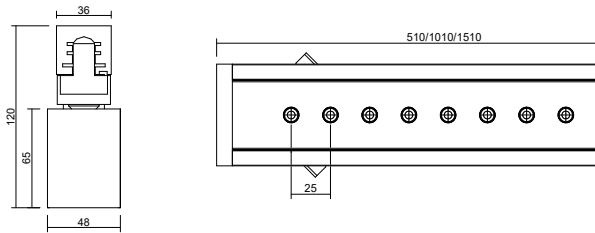

Produkt ID Länge / length	Bestromung, Leistung + Lichtstrom/ Current, wattage + luminous flux	
	002 = 2W / LED	@700mA
1833 = 510mm	40W / (3027 lm / 3818 lm)	
1834 = 1010mm	80W / (6054 lm / 7637 lm)	
1835 = 1510mm	120W / (9082 lm / 11455 lm)	

für/for 2700K-5000K, CRI80, 25°. Weitere Ausführungen auf Anfrage / Other versions on request

TINZO LINE 65 STROMSCHIENE / TRACK LP50

Lichtpunktabstand 50mm / Light point distance 50mm

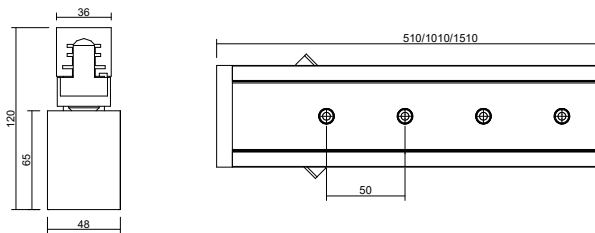

Produkt ID Länge / length	Bestromung, Leistung + Lichtstrom/ Current, wattage + luminous flux	
	002 = 2W / LED	@700mA
1836 = 510mm	20W / (1514 lm / 1909 lm)	
1837 = 1010mm	40W / (3027 lm / 3818 lm)	
1838 = 1510mm	60W / (4541 lm / 5728 lm)	

für/for 2700K-5000K, CRI80, 25°. Weitere Ausführungen auf Anfrage / Other versions on request

TINZO LINE 65 STROMSCHIENE / TRACK LP100

Lichtpunktabstand 100mm / Light point distance 100mm

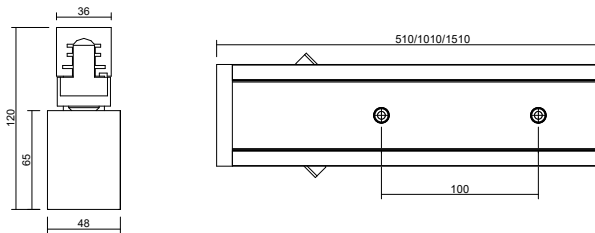

Produkt ID Länge / length	Bestromung, Leistung + Lichtstrom/ Current, wattage + luminous flux	
	002 = 2W / LED	@700mA
1839 = 510mm	10W / (757 lm / 955 lm)	
1840 = 1010mm	20W / (1514 lm / 1909 lm)	
1841 = 1510mm	30W / (2270 lm / 2864 lm)	

für/for 2700K-5000K, CRI80, 25°. Weitere Ausführungen auf Anfrage / Other versions on request

Lichtquelle Energieeffizienz
Light source energy efficiency
2700K - 5000K



ARTIKELNUMMER / ARTICLE NUMBER:



Produktkennung Product ID	Verbrauch Wattage	Treiber Driver	Abstrahlwinkel Beam Angle	Farbtemperatur Color Temperature	CRI CRI	Farbe Color Finish	Extras Accessories
1833	002 = 2W	X = Ohne/None	A = Asymmetric	T1 = 2200K - 4000K	8 = 80	01 = RAL 9016 ○	X = Ohne/None
1834		W = DALI DT8	f = 8°	T2 = 2200K - 4500K	9 = 90	02 = RAL 9006 ●	
1835			g = 10°	T3 = 2200K - 5000K		03 = RAL 9005 ●	
1836			T = 25°	T4 = 2200K - 5700K*		04 = RAL 7016 ●	
1837			h = 32°	T5 = 2700K - 4000K		05 = DB703 ●	
1838			W = 45°	T6 = 2700K - 4500K			
1839				T7 = 2700K - 5000K			
1840				T8 = 2700K - 5700K*			
1841							

Andere Farbkombinationen oder Temperaturen möglich / Other color combinations or temperatures possible

*5700K nur CRI 80 / 5700K only CRI 80