

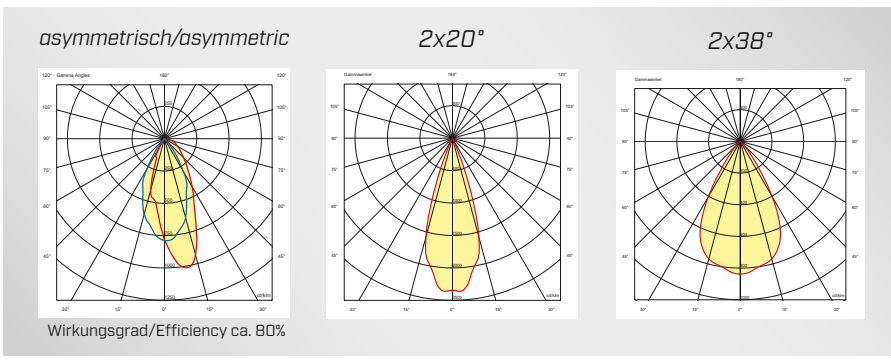

Lichtpunktabstand/Light point distance:	25mm, 50mm, 100mm
Treiber/Driver:	Extern/External
Leistung/Wattage:	5W – 120W
Leuchtenlichtstrom/Real Luminous Flux:	483lm – 7753 lm
Lichtverteilung/Beam angle:	2x20°, 2x38°, asymmetrisch/asymmetric
Max. Wirkungsgrad/Max. Efficiency:	ca. 71%
Farbtemperatur/Color Temperature:	2200K – 5700K
CRI:	>80, >90
Schutzklasse/Protection Class:	III
Schutzart/IP-Protection:	IP20
Oberfläche Gehäuse/Casing Finish:	Pulverbeschichtet/Powder Coated
Sonderausführung/Custom versions:	Auf Anfrage/On request





LFO LINE 35 EINBAU/RECESSED LP25 (40 LEDS/m)

Lichtpunktabstand 25mm/Light point distance 25mm

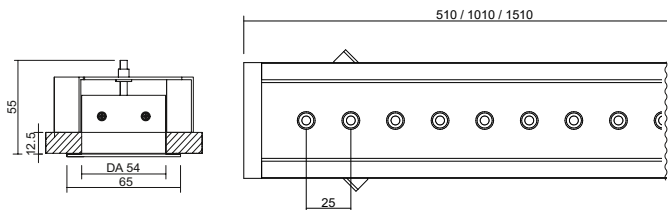

Produkt ID Länge / length	Bestromung, Leistung + Lichtstrom/ Current, wattage + luminious flux		
	@350mA 001 = 1W / LED	@500mA 015 = 1,5W / LED	@700mA 002 = 2W / LED
1427 = 510mm	20W / 1931 lm	30W / 2584 lm	X
1428 = 1010mm	40W / 3862 lm	60W / 5169 lm	X
1429 = 1510mm	60W / 5794 lm	90W / 7753 lm	X

für/for 3000K, CRI90 und 2x38° Weitere Ausführungen auf Anfrage / Other versions on request

LFO LINE 35 EINBAU/RECESSED LP50 (20 LEDS/m)

Lichtpunktabstand 50mm/Light point distance 50mm

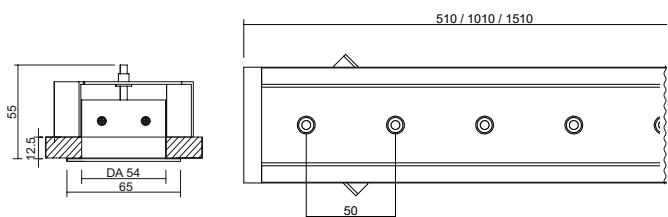

Produkt ID Länge / length	Bestromung, Leistung + Lichtstrom/ Current, wattage + luminious flux		
	@350mA 001 = 1W / LED	@500mA 015 = 1,5W / LED	@700mA 002 = 2W / LED
1430 = 510mm	10W / 966 lm	15W / 1292 lm	20W / 1718 lm
1431 = 1010mm	20W / 1931 lm	30W / 2584 lm	40W / 3436 lm
1432 = 1510mm	30W / 2897 lm	45W / 3877 lm	60W / 5155 lm

für/for 3000K, CRI90 und 2x38° Weitere Ausführungen auf Anfrage / Other versions on request

LFO LINE 35 EINBAU/RECESSED LP100 (10 LEDS/m)

Lichtpunktabstand 100mm/Light point distance 100mm

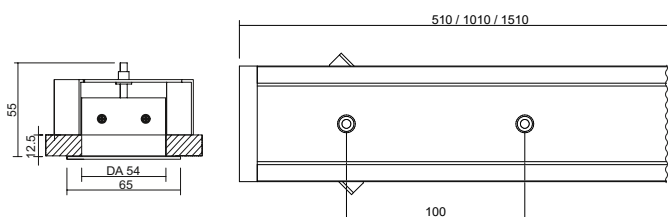

Produkt ID Länge / length	Bestromung, Leistung + Lichtstrom/ Current, wattage + luminious flux		
	@350mA 001 = 1W / LED	@500mA 015 = 1,5W / LED	@700mA 002 = 2W / LED
1433 = 510mm	5W / 483 lm	7,5W / 646 lm	10W / 859 lm
1434 = 1010mm	10W / 966 lm	15W / 1292 lm	20W / 1718 lm
1435 = 1510mm	15W / 1448 lm	22,5W / 1938 lm	30W / 2577 lm

für/for 3000K, CRI90 und 2x38° Weitere Ausführungen auf Anfrage / Other versions on request

Lichtquelle Energieeffizienz
Light source energy efficiency
3000K



ARTIKELNUMMER / ARTICLE NUMBER:



Produktkennung Product ID	Verbrauch Wattage	Treiber Driver	Abstrahlwinkel Beam Angle	Farbtemperatur Color Temperature	CRI CRI	Farbe Color Finish	Extras Accessories
1427	001 = 1W	X = Ohne/None	B = 2x20°	27 = 2700K	8 = 80	01 = RAL 9016 ○	X = Ohne/None
1428	015 = 1,5W	Y = DALI	F = 2x38°	30 = 3000K	9 = 90	02 = RAL 9006 ●	
1429	002 = 2W	Z = On/Off	A = Asymmetric	35 = 3500K		03 = RAL 9005 ●	
1430				40 = 4000K		04 = RAL 7016 ●	
1431				50 = 5000K*		05 = DB703 ●	
1432				57 = 5700K*			
1433							
1434							
1435							

Andere Farbkombinationen oder Temperaturen möglich/Other color combinations or temperatures possible

*5000K und 5700K nur CRI 80/ 5000K and 5700K only CRI 80

TUNABLE WHITE

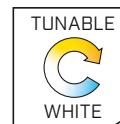
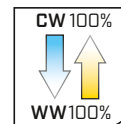

LFO LINE 35 EINBAU/RECESSED LP25 (40 LEDS/m)

Lichtpunktabstand 25mm/Light point distance 25mm

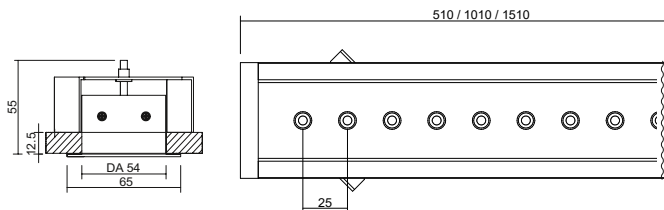

Produkt ID Länge / length	Bestromung, Leistung + Lichtstrom/ Current, wattage + luminous flux	
	002 = max. 2W per Lichtpunkt / Light point @700mA	
1436 = 510mm	40W / (2499 lm / 3152 lm)	
1437 = 1010mm	80W / (4998 lm / 6305 lm)	
1438 = 1510mm	120W / (7498 lm / 9457 lm)	

für/for 2700K-5000K, CRI90 und 2x38° Weitere Ausführungen auf Anfrage / Other versions on request

LFO LINE 35 EINBAU/RECESSED LP50 (20 LEDS/m)

Lichtpunktabstand 50mm/Light point distance 50mm

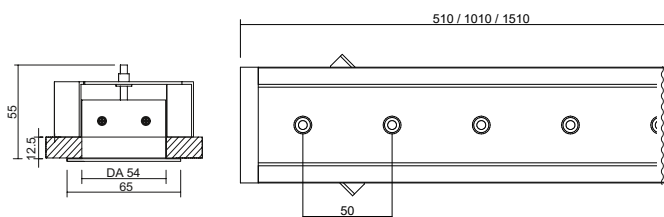

Produkt ID Länge / length	Bestromung, Leistung + Lichtstrom/ Current, wattage + luminous flux	
	002 = max. 2W per Lichtpunkt / Light point @700mA	
1439 = 510mm	20W / (1250 lm / 1576 lm)	
1440 = 1010mm	40W / (2499 lm / 3152 lm)	
1441 = 1510mm	60W / (3749 lm / 4729 lm)	

für/for 2700K-5000K, CRI90 und 2x38° Weitere Ausführungen auf Anfrage / Other versions on request

LFO LINE 35 EINBAU/RECESSED LP100 (10 LEDS/m)

Lichtpunktabstand 100mm/Light point distance 100mm

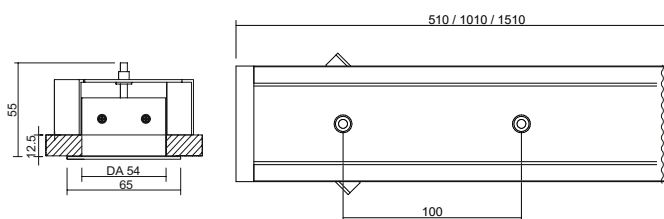

Produkt ID Länge / length	Bestromung, Leistung + Lichtstrom/ Current, wattage + luminous flux	
	002 = max. 2W per Lichtpunkt / Light point @700mA	
1442 = 510mm	10W / (625 lm / 788 lm)	
1443 = 1010mm	20W / (1250 lm / 1576 lm)	
1444 = 1510mm	30W / (1874 lm / 2364 lm)	

für/for 2700K-5000K, CRI90 und 2x38° Weitere Ausführungen auf Anfrage / Other versions on request

Lichtquelle Energieeffizienz
Light source energy efficiency
2700K - 5000K



ARTIKELNUMMER / ARTICLE NUMBER:



Produktkennung Product ID	Verbrauch Wattage	Treiber Driver	Abstrahlwinkel Beam Angle	Farbtemperatur Color Temperature	CRI CRI	Farbe Color Finish	Extras Accessories
1436	002 = 2W	X = Ohne/None	B = 2x20°	T1 = 2200K - 4000K	8 = 80	01 = RAL 9016 ○	X = Ohne/None
1437		W = DALI DT8	F = 2x38°	T2 = 2200K - 4500K	9 = 90	02 = RAL 9006 ●	
1438				T3 = 2200K - 5000K		03 = RAL 9005 ●	
1439				T4 = 2200K - 5700K*		04 = RAL 7016 ●	
1440				T5 = 2700K - 4000K		05 = DB703 ●	
1441				T6 = 2700K - 4500K			
1442				T7 = 2700K - 5000K			
1443				T8 = 2700K - 5700K*			
1444							

Andere Farbkombinationen oder Temperaturen möglich/Other color combinations or temperatures possible

*5700K nur CRI 80/ 5700K only CRI 80